

Project Overview

The Township of Puslinch recently completed a Recreation and Parks Master Plan, which was informed by public input. The Master Plan recommended the preparation of a **concept plan** the Puslinch Community Centre Park, including the newly acquired land at the rear of this site.

About the Park

Original park parcel: 5.7 hectares
Lands acquired (2012): 4.1 hectares
Total site: 9.8 hectares

The new lands are located within the floodplain of a tributary of Mill Creek. There is also a small wetland adjacent to the creek. As a result, **development restrictions** apply to the rear portion of the site, such as no buildings, paved parking, or changes in grading. Additional consultation with the GRCA will be undertaken prior to undertaking any site works.

Recreation and Parks Master Plan

The 2015 Recreation and Parks Master Plan recommended that the concept plans consider the following items:

- Two new grass soccer fields, one with lights (11v11) and one new smaller field (9v9)
- Development of unpaved trail loop
- Improved playground with barrier-free components
- Unpaved parking lot to serve expansion lands
- Splash pad (with community partner/fundraising)
- Club-led improvements to the existing tennis courts (including converting one court to a public court)

The Plan also suggested that the Township explore the **potential to re-purpose the lit ball diamond** to an alternative use due to low usage levels, pending capital repairs, and to improve flow and safety within the park.

Puslinch Community Centre Park Concept



Concept Plans

The design of the park has changed as new features have been added over time. Designing the expansion lands gives us an opportunity to examine the entire park.

Two preliminary concept plans have been prepared based on the directions contained in the Recreation and Parks Master Plan and the June 2012 stakeholder meeting where this matter was first discussed.

Both concepts are preliminary and include:

- nature trail loop
- new parking area
- picnic shelter and gazebo
- the relocation of the playground and Fair features (horse corral, tractor pull area)

Concept 1:

- two new full size soccer fields

Concept 2:

- removal of the ball diamond, replaced with large central hub (picnic area, playground, splash pad)
- two new soccer fields (one full size, one smaller)

Help Create a Vision for your Park

Your input will assist in refining these draft concepts and creating a long-term vision for this important community park!

Please fill out a comment sheet. These comments will become part of the public record and considered by Township Council.

Comments will be received up to **January 31, 2016** by Don Creed, Director of Public Works and Parks (dcreed@puslinch.ca).

Next Steps

The planning process is envisioned as follows:

1. Identify Preferred Concept Plan
2. Presentation to Council (early 2016)
3. Initiate Phase 2 (refine concept, costing)
4. Additional Consultation
5. Approvals and Project Initiation

Puslinch Community Centre Park Concept



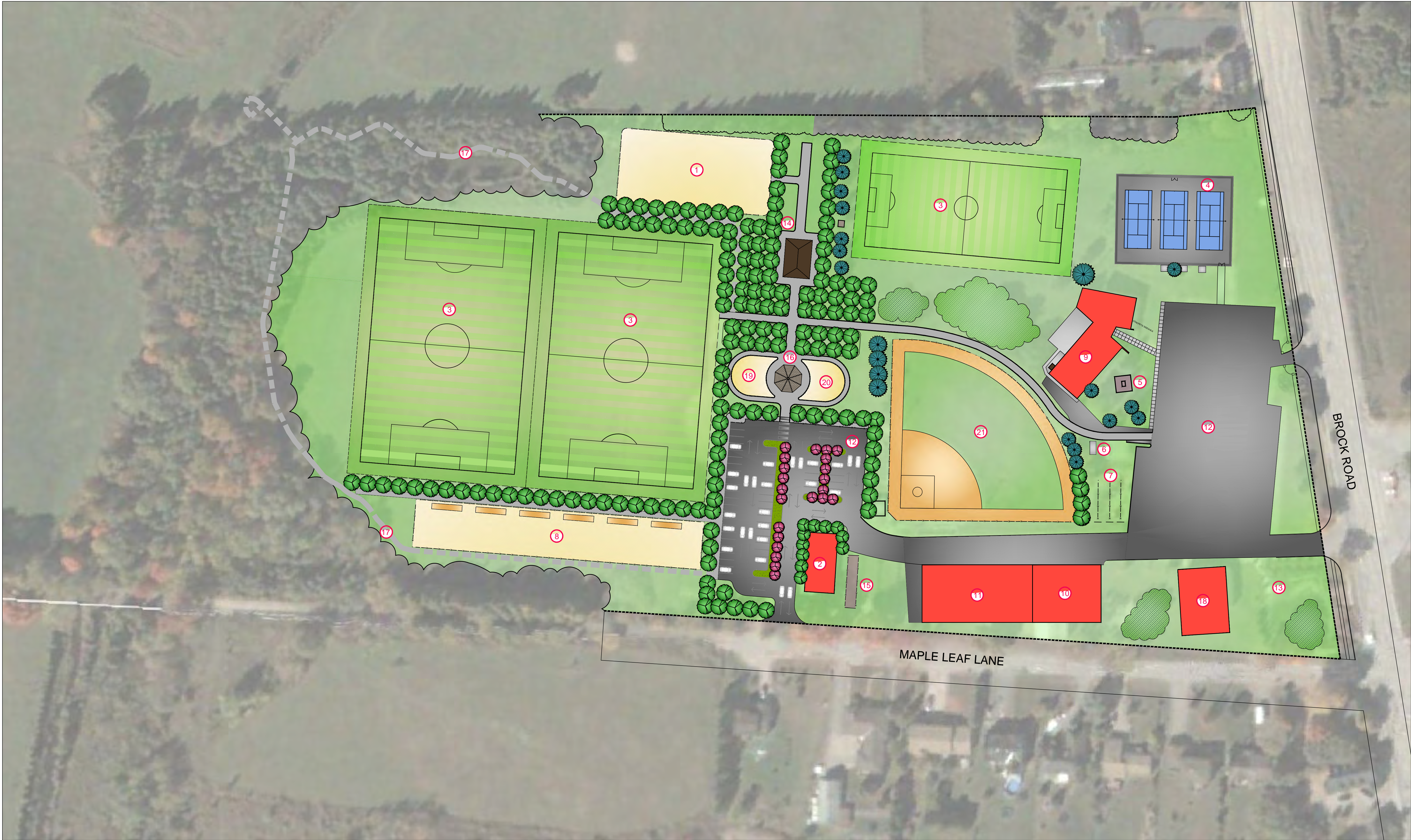

LEGEND

- 1 HORSE RIDING ARENA
- 2 WORKS BUILDING
- 3 SOCCER FIELD
- 4 TENNIS COURTS
- 5 WAR MEMORIAL STATUE
- 6 GARBAGE REMOVAL
- 7 HORSE SHOE PITS
- 8 TRACTOR PULL & BLEACHERS
- 9 COMMUNITY CENTRE
- 10 RECREATION CENTRE
- 11 COVERED ICE-PAD AREA
- 12 PARKING LOT
- 13 MILLENNIUM GARDEN
- 14 PICNIC SHELTER
- 15 PRACTICE BATTING CAGE
- 16 GAZEBO
- 17 PROPOSED TRAIL
- 18 PUBLIC LIBRARY
- 19 SENIOR PLAYGROUND
- 20 JUNIOR PLAYGROUND
- 21 BASEBALL FIELD



LEGEND

- 1 HORSE RIDING ARENA
- 2 WORKS BUILDING
- 3 SOCCER FIELD
- 4 TENNIS COURTS(EXISTING)
- 5 WAR MEMORIAL STATUE
- 6 GARBAGE REMOVAL
- 7 HORSE SHOE PITS
- 8 TRACTOR PULL & BLEACHERS
- 9 COMMUNITY CENTRE
- 10 RECREATION CENTRE
- 11 COVERED ICE-PAD AREA
- 12 PARKING LOT
- 13 MILLENNIUM GARDEN
- 14 PICNIC SHELTER
- 15 PICNIC AREA
- 16 GAZEBO
- 17 PROPOSED TRAIL
- 18 PUBLIC LIBRARY
- 19 PLAYGROUND
- 20 SPLASH PAD
- 21 SHRUBS GARDEN

What are your thoughts on Concept 1?

What are your thoughts on Concept 2?

Leave your input
on a sticky note or
comment sheet!

Puslinch Community Centre Park Concept



Is there anything else we should consider?



Leave your input
on a sticky note or
comment sheet!

Puslinch Community Centre Park Concept

