

LOVE

6.7(c)

Licensees Compliance Assessment Report - Aggregate Resources Act

| Background Information | | | | | | Year: 2014 | |
|---|--|----------------|---------------------|---------------------------|--|----------------------------|------------------|
| Licensee: Cox Construction Ltd. | | | Licence ID #: 20212 | | MNR District/Area Office: Guelph | | |
| Lot: 8 to 10 | | Conc: 4 | | Geographic Twp.: Puslinch | | Municipality: Wellington | |
| Observations | | | | | | | |
| OPERATING STANDARDS | | IN COMPLIANCE? | | | COMMENTS | | Remedial Action? |
| | | Yes | No | N/A | | | |
| A - Site Access | | | | | | | Y |
| A1 Boundaries (clearly marked) | | ✓ | | | | | |
| A2 Entrance and Exits (location/closed) | | ✓ | | | | | |
| A3 Lease/Ownership/Extraction Agreement | | Owner Operated | | | | | |
| B - Site Protection | | | | | | | |
| B4 Fencing | | | x | | Repairs required along Laird Road and northwest limits | | Y |
| B5 Fencing (site plan variation or temporary relief granted) | | ✓ | | | | | |
| B6 Screening (trees/benches) | | ✓ | | | | | |
| B7 Setbacks (15m / 30m or other) | | ✓ | | | | | |
| C - Operational Details | | | | | | | |
| C6 Operating Sequence | | ✓ | | | | | |
| C8 Stripping (overburden) | | ✓ | | | | | |
| C10 Overburden Seeded | | ✓ | | | | | |
| C11 Extraction Depth: | | ✓ | | | No extraction yet | Lowest floor elevation: NA | |
| C12 Buildings/Scales (location) | | ✓ | | | | | |
| C13 Equipment (any specific conditions or restrictions) | | ✓ | | | | | |
| C14 Plant (location/any specific conditions or restrictions) | | ✓ | | | | | |
| C15 Scrap (location/removal) | | ✓ | | | | | |
| C16 Stockpiles (location) | | ✓ | | | | | |
| C17 Topsoil (location/seeded) | | ✓ | | | | | |
| C18 Excavation Faces | | ✓ | | | | | |
| C19 Ponds (location/depth) | | ✓ | | | | | |
| C20 Internal Roads (any specific conditions or restrictions) | | ✓ | | | | | |
| C21 Haul Routes (external/any specific conditions or restrictions) | | ✓ | | | | | |
| C22 Blast Monitoring Report (quarries only) | | | | ✓ | | | |
| C23 Dust Suppression | | ✓ | | | | | |
| C24 Hours of Operation (any specific conditions or restrictions) | | ✓ | | | | | |
| C25 Well Monitoring Reports | | | x | | Water monitoring report required | | Y |
| C26 Identification Sign (as per Sect. 5.22 of Provincial Standards) | | ✓ | | | | | |
| C27 Orderly Conditions | | ✓ | | | | | |
| C28 Blasting Hours (quarries only) | | | | ✓ | | | |

| | |
|----------------------|------------------------|
| TO | MH |
| Copy | Form #591 (Rev. 04/03) |
| Please Handle | |
| For Your Information | |
| Council Agenda | ✓ |
| File | |

Note: Any (✓/No) requires completion of Page 3

RECEIVED

Page 1

OCT 01 2014

Township of Puslinch

[illegible]

- Page 3

| | | |
|-------------------------------------|------------|--|
| Date Submitted to MNR: Y / M / D | 14/ 09 /30 | Please ensure that the site plan you have is the most current, approved plan and is the same as the one MNR has on file. |
| Is the site held in reserve? No | | |

| | | | |
|---------------------------|------------------------------|--------------------|-------------------------------|
| Copies of Report Sent to: | County/Regional Municipality | Local Municipality | Ministry of Natural Resources |
| (by September 30th) | YES | YES | YES |

| TO BE COMPLETED BY PERSON CONDUCTING REVIEW (Including on-site inspection) | | | |
|---|----------|---|--|
| Date Inspected: Y / M / D | 14/09/11 | Review Conducted by: R Stovel (Please Print) | Signature (if different than licensee):  |
| Name of Company and Address: Stovel and Associates Inc. 297 Briarhill Drive, Stratford ON N5A 7T1 | | | |
| Position with Company: President | | | |

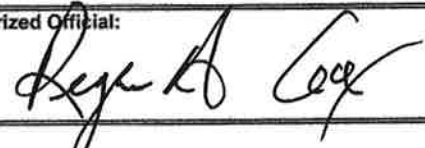
| |
|--|
| Signature of Licensee or Authorized Official:  |
|--|

| FOR MNR OFFICE USE ONLY | | | | |
|---|--|------------------------------|-----|----------------|
| Accepted by MNR: (✓ one) | YES <input type="checkbox"/> NO <input type="checkbox"/> | Date Accepted: Y / M / D | / / | MNR Signature: |
| Field Audit by MNR: (✓ one) | YES <input type="checkbox"/> NO <input type="checkbox"/> | Date Inspected: Y / M / D | / / | MNR Signature: |
| Follow up Notice Required? YES <input type="checkbox"/> NO <input type="checkbox"/> | | | | Licence ID #: |

- Pursuant to Subsection 57(4) of the ARA, it is an offence to furnish false information.
- You must provide a sketch if remedial action is required or progressive rehabilitation has been performed.
- In order to extend the 90-day remedial action deadline date, you must obtain the Aggregate Inspector's approval (in writing) prior to filing the report with the Inspector or local MNR office.
- Please submit this report to the local Aggregate Inspector who administers your site, or the local MNR office.

(NOTE: ALL INFORMATION IN RESPECT OF THIS REPORT IS AVAILABLE FOR PUBLIC REVIEW)

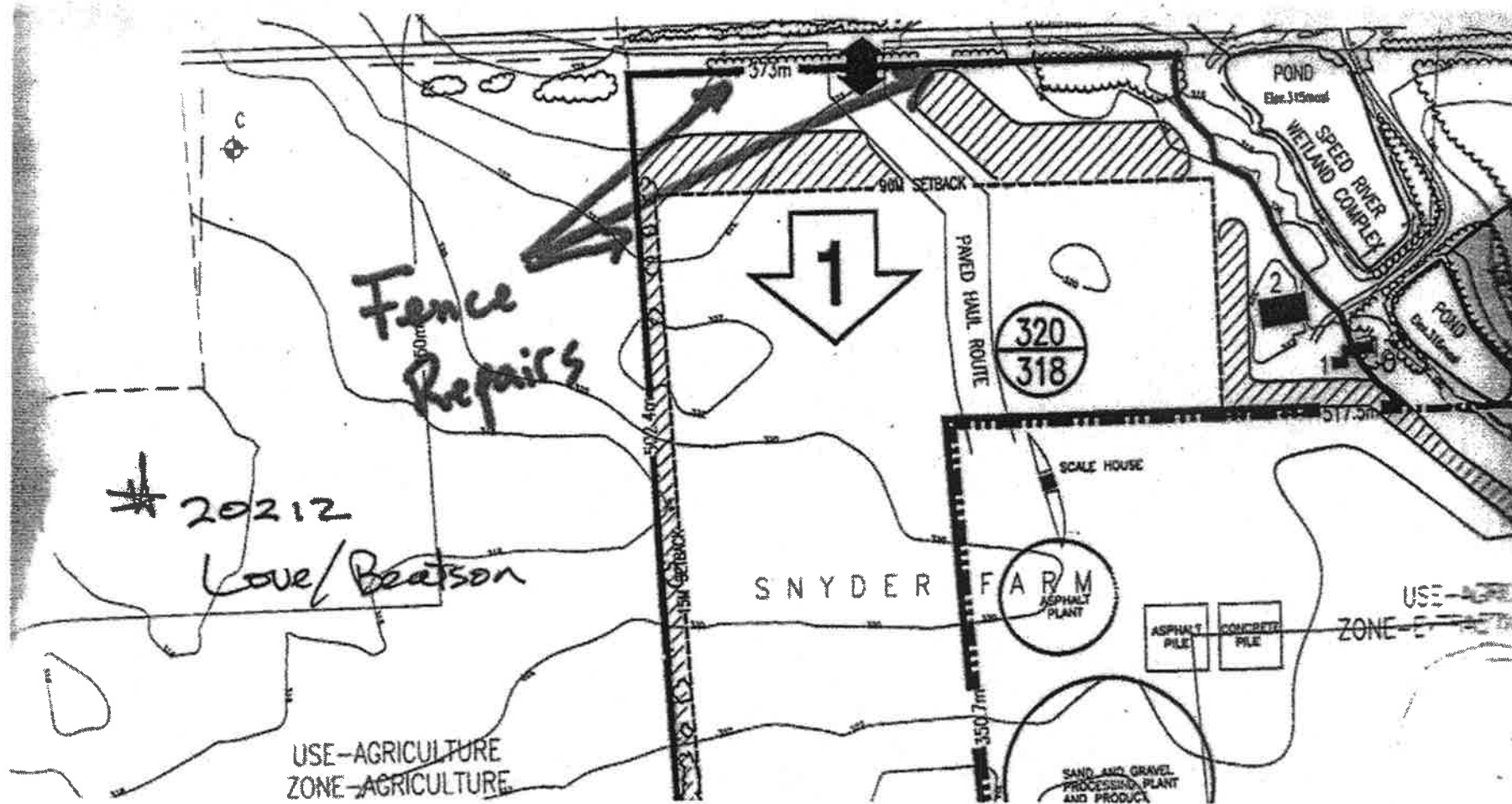

6.7CB)

N16A0

Licensees Compliance Assessment Report - Aggregate Resources Act

Background Information

Year: 2014

Licensee: Cox Construction Ltd.

Licence ID #: 20749 (Nigro)

MNR District/Area Office: Guelph

Lot: 11 & 12

Conc.: 4

Geographic Twp.: Puslinch

Municipality: Puslinch (County of Wellington)

Observations

| OPERATING STANDARDS | IN COMPLIANCE? | | | COMMENTS | Remedial Action? |
|---|----------------|----|-----|-------------------------------------|------------------|
| | Yes | No | N/A | | |
| A - Site Access | | | | | Y |
| A1 Boundaries (clearly marked) | √ | | | | |
| A2 Entrance and Exits (location/closed) | √ | | | | |
| A3 Lease/Ownership/Extraction Agreement Owner Operated | | | | | |
| B - Site Protection | | | | | |
| B4 Fencing | √ | | | | |
| B5 Fencing (site plan variation or temporary relief granted) | √ | | | | |
| B6 Screening (trees/berms) | √ | | | | |
| B7 Setbacks (15m / 30m or other) | √ | | | | |
| C - Operational Details | | | | | |
| C8 Operating Sequence | √ | | | | |
| C9 Stripping (overburden) | √ | | | | |
| C10 Overburden Seeded | √ | | | | |
| C11 Extraction Depth | √ | | | Lowest floor elevation +/- 323 masl | |
| C12 Buildings/Scales (location) | √ | | | | |
| C13 Equipment (any specific conditions or restrictions) | √ | | | | |
| C14 Plant (location/any specific conditions or restrictions) | √ | | | | |
| C15 Scrap (location/removal) | √ | | | | |
| C16 Stockpiles (location) | √ | | | | |
| C17 Topsoil (location/seeded) | √ | | | | |
| C18 Excavation Faces | √ | | | | |
| C19 Ponds (location/depth) | √ | | | | |
| C20 Internal Roads (any specific conditions or restrictions) | √ | | | | |
| C21 Haul Routes (external/any specific conditions or restrictions) | √ | | | | |
| C22 Blast Monitoring Report (quarries only) | | | √ | | |
| C23 Dust Suppression | √ | | | | |
| C24 Hours of Operation (any specific conditions or restrictions) | √ | | | | |
| C25 Well Monitoring Reports | | | √ | | |
| C26 Identification Sign (as per Sect. 5.22 of Provincial Standards) | √ | | | | |
| C27 Orderly Conditions | √ | | | | |
| C28 Blasting Hours (quarries only) | | | √ | | |

CLERK'S DEPARTMENT

TO *MH*
Form #591 (Rev. 04/03)

Please Handle

For Your Information

Council Agenda

File

Note: Any (✓"No") requires completion of Page 3

RECEIVED

Page 1

OCT 01 2014

Township of Puslinch

[illegible]

- Form #591 (Rev. 04/03)

| | | |
|-------------------------------------|------------|--|
| Date Submitted to MNR: Y / M / D | 14/ 09 /30 | Please ensure that the site plan you have is the most current, approved plan and is the same as the one MNR has on file. |
| Is the site held in reserve? No | | |

| | | | |
|---------------------------|------------------------------|--------------------|-------------------------------|
| Copies of Report Sent to: | County/Regional Municipality | Local Municipality | Ministry of Natural Resources |
| (by September 30th) | YES | YES | YES |

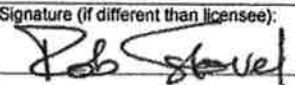
| TO BE COMPLETED BY PERSON CONDUCTING REVIEW (including on-site inspection) | | | |
|---|----------|---|---|
| Date Inspected: Y / M / D | 14/09/11 | Review Conducted by: R Stovel (Please Print) | Signature (if different than licensee):  |
| Name of Company and Address: Stovel and Associates Inc. 297 Briarhill Drive, Stratford ON N5A 7T1 | | | |
| Position with Company: President | | | |

| |
|--|
| Signature of Licensee or Authorized Official:  |
|--|

| FOR MNR OFFICE USE ONLY | | | | |
|--|--|------------------------------|-----|----------------|
| Accepted by MNR: (✓ one) | YES <input type="checkbox"/> NO <input type="checkbox"/> | Date Accepted: Y / M / D | / / | MNR Signature: |
| Field Audit by MNR: (✓ one) | YES <input type="checkbox"/> NO <input type="checkbox"/> | Date Inspected: Y / M / D | / / | MNR Signature: |
| Follow up Notice Required? | | Licence ID #: | | |
| YES <input type="checkbox"/> NO <input type="checkbox"/> | | | | |

- Pursuant to Subsection 57(4) of the ARA, it is an offence to furnish false information.
- You must provide a sketch if remedial action is required or progressive rehabilitation has been performed.
- In order to extend the 90-day remedial action deadline date, you must obtain the Aggregate Inspector's approval (in writing) prior to filing the report with the Inspector or local MNR office.
- Please submit this report to the local Aggregate Inspector who administers your site, or the local MNR office.

(NOTE: ALL INFORMATION IN RESPECT OF THIS REPORT IS AVAILABLE FOR PUBLIC REVIEW)

6.7(c)

PUSLINCH EXT.

Licensees Compliance Assessment Report - Aggregate Resources Act

Background Information

Year: 2014

Licensee: Cox Construction Ltd.

Licence ID #: 524889

MNR District/Area Office: Guelph

Lot: 13

Concd.: 4

Geographic Twp.: Puslinch

Municipality: Wellington

Observations

| OPERATING STANDARDS | IN COMPLIANCE? | | | COMMENTS | Remedial Action? |
|---|----------------|----|-----|-----------------------------------|------------------|
| | Yes | No | N/A | | |
| A - Site Access | | | | | |
| A1 Boundaries (clearly marked) | | x | | Northern boundary to be re-staked | Y |
| A2 Entrance and Exits (location/closed) | ✓ | | | | |
| A3 Lease/Ownership/Extraction Agreement | | | | Owner Operated | |
| B - Site Protection | | | | | |
| B4 Fencing | ✓ | | | | |
| B5 Fencing (site plan variation or temporary relief granted) | ✓ | | | | |
| B6 Screening (trees/berms) | ✓ | | | | |
| B7 Setbacks (15m / 30m or other) | ✓ | | | | |
| C - Operational Details | | | | | |
| C8 Operating Sequence | ✓ | | | | |
| C8 Stripping (overburden) | ✓ | | | | |
| C10 Overburden Seeded | ✓ | | | | |
| C11 Extraction Depth | ✓ | | | Lowest floor elevation +/- 328 m | |
| C12 Buildings/Scales (location) | ✓ | | | No buildings or scales | |
| C13 Equipment (any specific conditions or restrictions) | ✓ | | | | |
| C14 Plant (location/any specific conditions or restrictions) | ✓ | | | | |
| C15 Scrap (location/removal) | ✓ | | | | |
| C16 Stockpiles (location) | ✓ | | | | |
| C17 Topsoil (location/seeded) | ✓ | | | | |
| C18 Excavation Faces | ✓ | | | | |
| C19 Ponds (location/depth) | ✓ | | | | |
| C20 Internal Roads (any specific conditions or restrictions) | ✓ | | | | |
| C21 Haul Routes (external/any specific conditions or restrictions) | ✓ | | | | |
| C22 Blast Monitoring Report (quarries only) | | | ✓ | | |
| C23 Dust Suppression | ✓ | | | | |
| C24 Hours of Operation (any specific conditions or restrictions) | ✓ | | | | |
| C25 Well Monitoring Reports | ✓ | | | | |
| C26 Identification Sign (as per Sect. 5.22 of Provincial Standards) | ✓ | | | | |
| C27 Orderly Conditions | ✓ | | | | |
| C28 Blasting Hours (quarries only) | | | ✓ | | |

Note: Any (✓"No") requires completion of Page 3

Page 1

| | |
|------------------------|----|
| CLERK'S DEPARTMENT | |
| Form #591 (Rev. 04/03) | MH |
| Copy | |
| Please Handle | |
| For Your Information | |
| | ✓ |

RECEIVED

OCT 01 2014

Township of Puslinch

[illegible]

- Form #591 (Rev. 04/03)

| | | |
|-------------------------------------|------------|--|
| Date Submitted to MNR: Y / M / D | 14/ 09 /30 | Please ensure that the site plan you have is the most current, approved plan and is the same as the one MNR has on file. |
| Is the site held in reserve? NO | | |

| | | | |
|---------------------------|------------------------------|--------------------|-------------------------------|
| Copies of Report Sent to: | County/Regional Municipality | Local Municipality | Ministry of Natural Resources |
| (by September 30th) | YES | YES | YES |

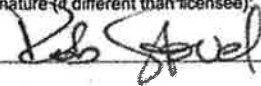
| TO BE COMPLETED BY PERSON CONDUCTING REVIEW (including on-site inspection) | | | |
|---|----------|---|---|
| Date Inspected: Y / M / D | 14/09/11 | Review Conducted by: R Stovel (Please Print) | Signature (if different than licensee)  |
| Name of Company and Address: Stovel and Associates Inc. 297 Briarhill Drive, Stratford ON N5A 7T1 | | | |
| Position with Company: President | | | |

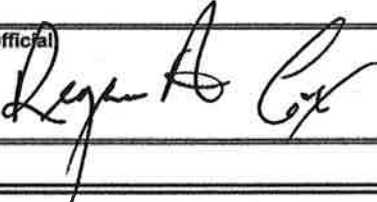
| |
|---|
| Signature of Licensee or Authorized Official  |
|---|

| FOR MNR OFFICE USE ONLY | | | | |
|--------------------------------|--|--|-----|----------------|
| Accepted by MNR: (✓ one) | YES <input type="checkbox"/> NO <input type="checkbox"/> | Date Accepted: Y / M / D | / / | MNR Signature: |
| Field Audit by MNR: (✓ one) | YES <input type="checkbox"/> NO <input type="checkbox"/> | Date Inspected: Y / M / D | / / | MNR Signature: |
| Follow up Notice Required? | | YES <input type="checkbox"/> NO <input type="checkbox"/> | | Licence ID #: |

- Pursuant to Subsection 57(4) of the ARA, it is an offence to furnish false information.
- You must provide a sketch if remedial action is required or progressive rehabilitation has been performed.
- In order to extend the 90-day remedial action deadline date, you must obtain the Aggregate Inspector's approval (in writing) prior to filing the report with the Inspector or local MNR office.
- Please submit this report to the local Aggregate Inspector who administers your site, or the local MNR office.

(NOTE: ALL INFORMATION IN RESPECT OF THIS REPORT IS AVAILABLE FOR PUBLIC REVIEW)

Cox 624889
Pushinch Pit Expansion (South part).

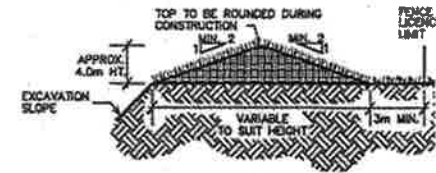
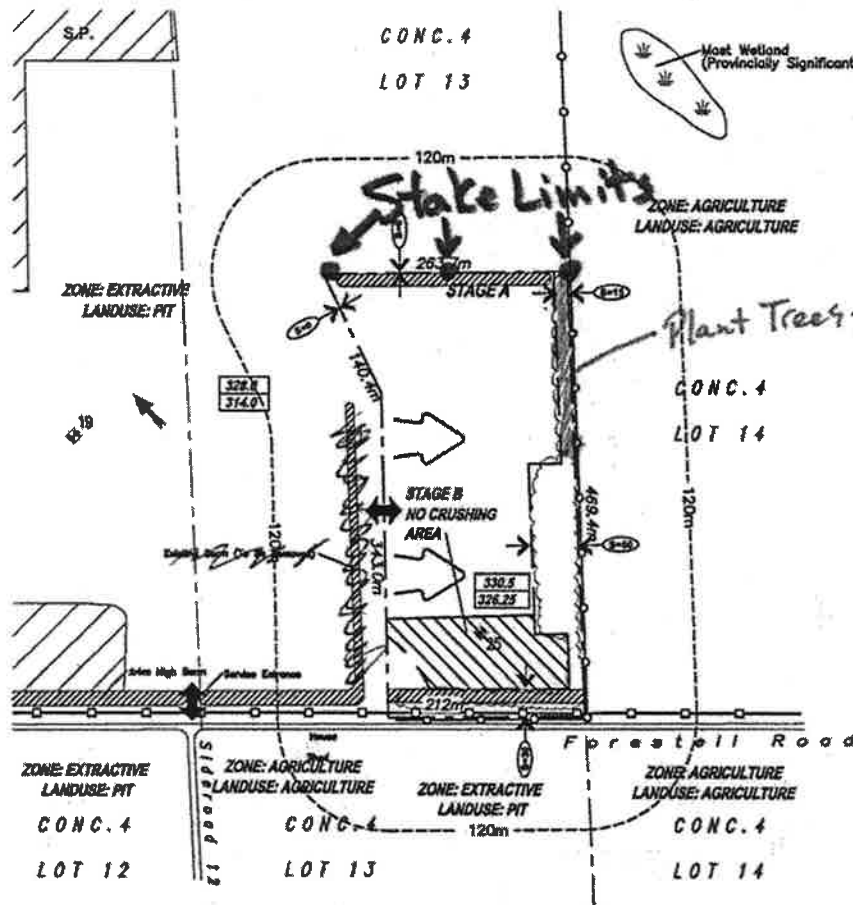

PROPERTY BASED UPON THE BEST INFORMATION AVAILABLE. ELEVATIONS MAY VARY SLIGHTLY WITH DEMAND AND VARIATIONS IN EXCAVATION TIME PERIOD. EXTRACTION OF THIS SITE WILL BE BY COX CONSTRUCTION LTD.

TABLE. THESE LANDS ARE TO BE REMEDIATED BACK TO ORIGINAL CONDITION. THE REMEDIATION PLAN IS TO BE COORDINATED WITH THE (LICENCE No. 5710). THE SITE WILL BE WORKED FROM THE EXISTING PIT. THE SITE WILL BE SHIPPED ONTO LICENCE No. 5710 AND KET VIA THE EXISTING PIT ONTO LAIRD ROAD.

TECHNOLOGIES AND FROM ONTARIO BASE MAP. THE SITE ARE SHOWN AT A TWO METRE INTERVAL.

EXISTING VEGETATION.

EXISTING BUILDINGS ON THE SITE AND WITHIN

BY THE LICENSEE. AREA TO BE EXTRACTED IS

APPROXIMATELY 324 MASH TO 324.78 MASH.

PLACED IN BERTS OR STOCKPILES. ANY SURPLUS MATERIAL SHALL BE PLACED IN STOCKPILES WITH A MAXIMUM HEIGHT OF 10 METRES AND OVERBURDEN SHALL BE GRADED TO STABLE SLOPE AND TO MINIMIZE DUST.

17. IT IS A CONDITION OF THIS LICENCE THAT NO MORE THAN 341,000 TONNES OF MATERIAL SHALL BE REMOVED FROM THIS LICENCED PROPERTY ANNUALLY IN COMBINATION WITH THE ADJACENT LICENCED SITE IN THE NAME OF COX CONSTRUCTION LIMITED, LICENCE NUMBER 5710 (IE. THE COMBINED TOTAL ANNUAL TONNAGE REMOVED FROM THESE TWO LICENCED PITS WILL NOT EXCEED 341,000 TONNES IN ANY CALENDAR YEAR). ANY INCREASE BEYOND THIS CUMULATIVE TONNAGE LIMIT TO SATISFY A PUBLIC CONTRACT WILL REQUIRE APPROVAL FROM THE TOWNSHIP OF PUSHINCH AND MNR.

18. RE-SEEDING WILL OCCUR IMMEDIATELY AFTER CONTOURING TO ENCOURAGE VEGETATION GROWTH AS SOON AS POSSIBLE.

LEGEND

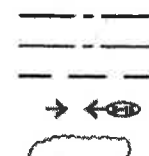

6:7(d)

PUSLINCH

Licensees Compliance Assessment Report - Aggregate Resources Act

Background Information

Year: 2014

Licensee: Cox Construction Ltd.

Licence ID #: 5710

MNR District/Area Office: Guelph

Lot: 9 to 13

Conc.: 4

Geographic Twp.: Puslinch

Municipality: Wellington

Observations

| OPERATING STANDARDS | IN COMPLIANCE? | | | COMMENTS | Remedial Action? |
|---|----------------|----|--|----------|------------------|
| | Yes | No | N/A | | |
| A - Site Access | | | | | Y |
| A1 Boundaries (clearly marked) | | x | Stake northern and western limits in lot 9 and 10 | | Y |
| A2 Entrance and Exits (location/closed) | √ | | | | |
| A3 Lease/Ownership/Extraction Agreement Owner operated | | | | | |
| B - Site Protection | | | | | |
| B4 Fencing | √ | | | | |
| B5 Fencing (site plan variation or temporary relief granted) | √ | | | | |
| B6 Screening (trees/berms) | | x | Repair berms in northern and southeastern part of pit | | Y |
| B7 Setbacks (15m / 30m or other) | √ | | | | |
| C - Operational Details | | | | | |
| C8 Operating Sequence | √ | | | | |
| C9 Stripping (overburden) | √ | | | | |
| C10 Overburden Seeded | √ | | | | |
| C11 Extraction Depth | √ | | Lowest floor elevation ± 318m | | |
| C12 Buildings/Scales (location) | √ | | Asphalt plant constructed in 2011 west of SR 10 | | |
| C13 Equipment (any specific conditions or restrictions) | √ | | | | |
| C14 Plant (location/any specific conditions or restrictions) | √ | | Processing plant follows pit face (recommend staking no processing area in SE of Lot 10) | | |
| C15 Scrap (location/removal) | √ | | | | |
| C16 Stockpiles (location) | √ | | | | |
| C17 Topsoil (location/seeded) | √ | | | | |
| C18 Excavation Faces | √ | | | | |
| C19 Ponds (location/depth) | √ | | Wash pond ± 200m behind former asphalt plant in Lot 12/13 | | |
| C20 Internal Roads (any specific conditions or restrictions) | √ | | | | |
| C21 Haul Routes (external/any specific conditions or restrictions) | √ | | | | |
| C22 Blast Monitoring Report (quarries only) | | | √ | | |
| C23 Dust Suppression | √ | | Water used as required | | |
| C24 Hours of Operation (any specific conditions or restrictions) | √ | | | | |
| C25 Well Monitoring Reports | | x | To follow | | Y |
| C26 Identification Sign (as per Sect. 5.22 of Provincial Standards) | √ | | | | |
| C27 Orderly Conditions | √ | | | | |
| C28 Blasting Hours (quarries only) | | | √ | | |

CLERK'S DEPARTMENT

Form #591 (Rev. 04/03) MH

Copy

Please Handle

For Your Information

Council Agenda

File

Note: Any (✓"No") requires completion of Page 3

RECEIVED

OCT 01 2014

Township of Puslinch

Page 1

| Observations (continued) | | | | | | |
|---|----------------|----|-----|------------------------------------|------------------------------|--|
| OPERATING STANDARDS | IN COMPLIANCE? | | | COMMENTS | Remedial Action? | |
| | Yes | No | N/A | | | |
| D - Rehabilitation | | | | | | |
| D29 Disturbed Hectareage | ✓ | | | Current year - # of hectares 0 | Total # of hectares ± 90.0 | |
| D30 Progressive rehabilitation | ✓ | | | Current year - # of hectares +/- 1 | Total # of hectares +/- 52.0 | |
| D31 Sloping of Faces | ✓ | | | | | |
| D32 Grades/Contours/Elevations | ✓ | | | | | |
| D33 Importation of Material (Inert) | ✓ | | | | | |
| D34 Vegetation | ✓ | | | | | |
| D35 Final Rehabilitation | ✓ | | | | | |
| E - Prescribed Conditions (For Licences issued after June 27, 1997) | | | | | | |
| E36 Other Monitoring Reports | | | ✓ | | | |
| E37 Requirements of C of A's | ✓ | | | | | |
| E38 Noise Mitigation | | | ✓ | | | |
| E39 Fuel Storage Tanks | | | ✓ | | | |
| E40 Spills Plan | | | ✓ | | | |
| E41 Permit to Take Water | ✓ | | | | | |
| E42 Dust Suppression Measures Req'd. (Haul routes, equip, etc.) | | | ✓ | | | |
| F - Other Conditions (As indicated on either Site Plan or Licence) | | | | | | |
| F43 tonnage | ✓ | | | | | |
| F44 | | | | | | |
| F45 | | | | | | |
| General Comments: | | | | | | |
| Cox has opened a pit west of Sideroad 10. Extraction is moving south and is about ½ through the farm. Cox has re-established the asphalt plant west of SR 10. | | | | | | |
| Cox has rehabilitated the lands east of SR 10. | | | | | | |
| Much of Lot 11, Concession 4 has been rehabilitated. | | | | | | |
| Berms are established along Forestall Road. The berm along east part of SR 10 is being used for progressive rehabilitation. | | | | | | |
| It is recommended that setbacks continue to be staked (although not required) in NE and SE corners of Lot 10 prior to operation in 2015. | | | | | | |
| The extent of below water extraction will be smaller than predicted. These lands will be returned to agriculture. | | | | | | |
| | | | | | | |
| | | | | | | |
| | | | | | | |
| | | | | | | |
| | | | | | | |
| | | | | | | |
| | | | | | | |
| | | | | | | |
| | | | | | | |
| Licence ID#: 5710 | | | | | | |

Note: Any (✓/No) requires completion of Page 3

[illegible]

- Form #591 (Rev. 04/03)

| | | |
|-------------------------------------|----------|--|
| Date Submitted to MNR: Y / M / D | 14/09/30 | Please ensure that the site plan you have is the most current, approved plan and is the same as the one MNR has on file. |
| Is the site held in reserve? NO | | |

| | | | |
|---------------------------|------------------------------|--------------------|-------------------------------|
| Copies of Report Sent to: | County/Regional Municipality | Local Municipality | Ministry of Natural Resources |
| (by September 30th) | YES | YES | YES |

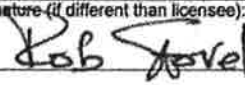
| TO BE COMPLETED BY PERSON CONDUCTING REVIEW (Including on-site inspection) | | | |
|---|----------|---|--|
| Date Inspected: Y / M / D | 14/09/11 | Review Conducted by: Rob Stovel (Please Print) | Signature (if different than licensee):  |
| Name of Company and Address: Stovel and Associates Inc. 287 Briarhill Drive, Stratford ON N5A 7T1 | | | |
| Position with Company: President | | | |

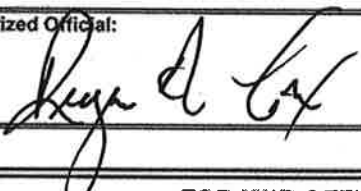
| |
|--|
| Signature of Licensee or Authorized Official:  |
|--|

| FOR MNR OFFICE USE ONLY | | | | |
|---|--|------------------------------|-----|----------------|
| Accepted by MNR: (✓ one) | YES <input type="checkbox"/> NO <input type="checkbox"/> | Date Accepted: Y / M / D | / / | MNR Signature: |
| Field Audit by MNR: (✓ one) | YES <input type="checkbox"/> NO <input type="checkbox"/> | Date Inspected: Y / M / D | / / | MNR Signature: |
| Follow up Notice Required? YES <input type="checkbox"/> NO <input type="checkbox"/> | | | | Licence ID #: |

- Pursuant to Subsection 57(4) of the ARA, it is an offence to furnish false information.
- You must provide a sketch if remedial action is required or progressive rehabilitation has been performed.
- In order to extend the 90-day remedial action deadline date, you must obtain the Aggregate Inspector's approval (in writing) prior to filing the report with the Inspector or local MNR office.
- Please submit this report to the local Aggregate Inspector who administers your site, or the local MNR office.

(NOTE: ALL INFORMATION IN RESPECT OF THIS REPORT IS AVAILABLE FOR PUBLIC REVIEW)

Cox #5710

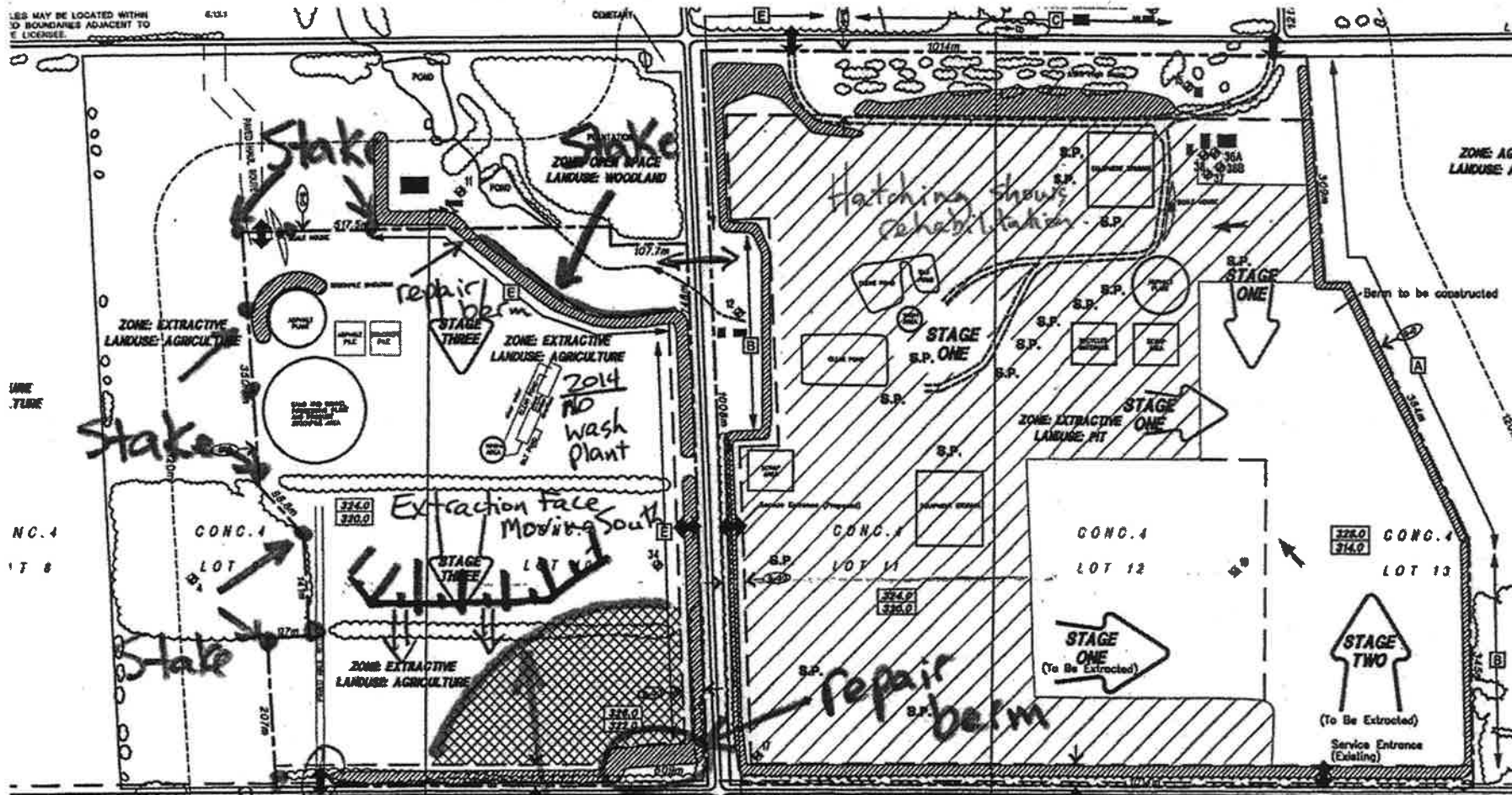

Suggest:
Stake No Processing Area

2014 - no
entrance