

Schedule A - Overview

Highways 6 & 401 Hamilton North Limits to Guelph South Limits

Phase 2: GWP 3059-20-00 – Midblock Interchange

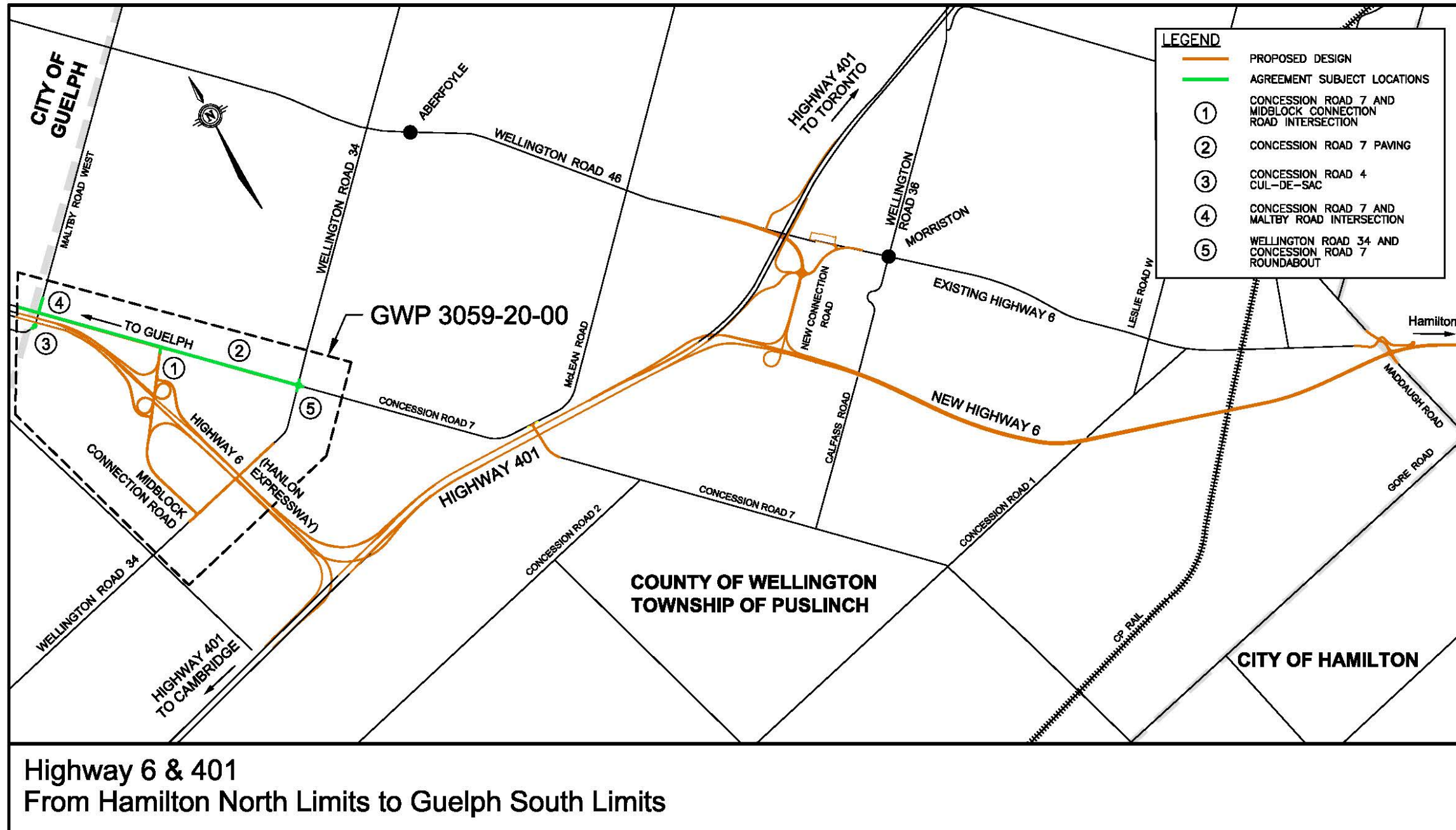

Schedule B – Details

Highways 6 & 401 Hamilton North Limits to Guelph South Limits

Phase 2: GWP 3059-20-00 – Midblock Interchange

Table 1 - Concession Road 7 – Geometric Design Parameters

Design Year: 2041	Superelevation Maximum Rate for Determining the Radius: 6 %		
	Present Conditions	Design Standards	Proposed Standards
Functional Highway Classification	RLU 50	RAU 80	RAU 80
Minimum Stopping Sight Distance (m)	60	130	>130
Crest: Minimum “K” factor for Stopping Sight Distance	4	25	35
Sag: Minimum “K” factor for Stopping Sight Distance	4	30	30
Grades Maximum (%)	11.5	6 - 8	4.0
Radius Minimum (m)	N/A	250	3000
Lane Widths (m)	2 x 3.0	2 x 3.25	2 x 3.5
Shoulder Width (Left / Right) (m)	1.0	2.5	1.0 – 2.5 (a)
Shoulder Rounding (m)	0	0.5	0.5
Median Width (m)	N/A	N/A	N/A
R.O.W. Width - nominal (m)	20	X	55
Posted Speed - prevailing (km/h)	60	70	70
Roundabout Inscribed Circle Diameter (m)	N/A	42-46	42-46
Miscellaneous	N/A	N/A	N/A

Table 2 - Preliminary Pavement Design for Concession Road 7

Preliminary Pavement recommendations for Concession Road 7	
Asphalt	170 mm
Granular A	150 mm *
Granular B	600 mm *

\* In areas where property constraints may not allow construction of the above pavement structures, a thinner overall pavement structure meeting the pavement structural design requirements of the pavement structures shown above may be considered, with the provision of a suitable surface and subsurface drainage system with subdrains or ditches leading to a positive outlet. The minimum asphalt pavement shall remain as indicated.

Extend the top two asphalt lifts for all paved shoulders.

Table 3 - Illumination Provisions

Location	Illumination Details
Intersection of Midblock Connection Road and Concession Road 7	<ul style="list-style-type: none"> <li>Partial illumination shall be designed in accordance with MTO standards in consultation with Township of Puslinch</li> <li>Luminaires shall be LED fixtures chosen from the DSM listed manufacturers.</li> </ul>
Intersection of Wellington Road 34 and Concession Road 7	<ul style="list-style-type: none"> <li>Full illumination shall be designed in accordance with MTO standards in consultation with Wellington County</li> <li>Luminaires shall be LED fixtures chosen from the DSM listed manufacturers.</li> </ul>

Notes:

- a) The shoulders on the west side of Concession Road 7, south of Wellington Road 34, are 1.0 m and tie into existing conditions.

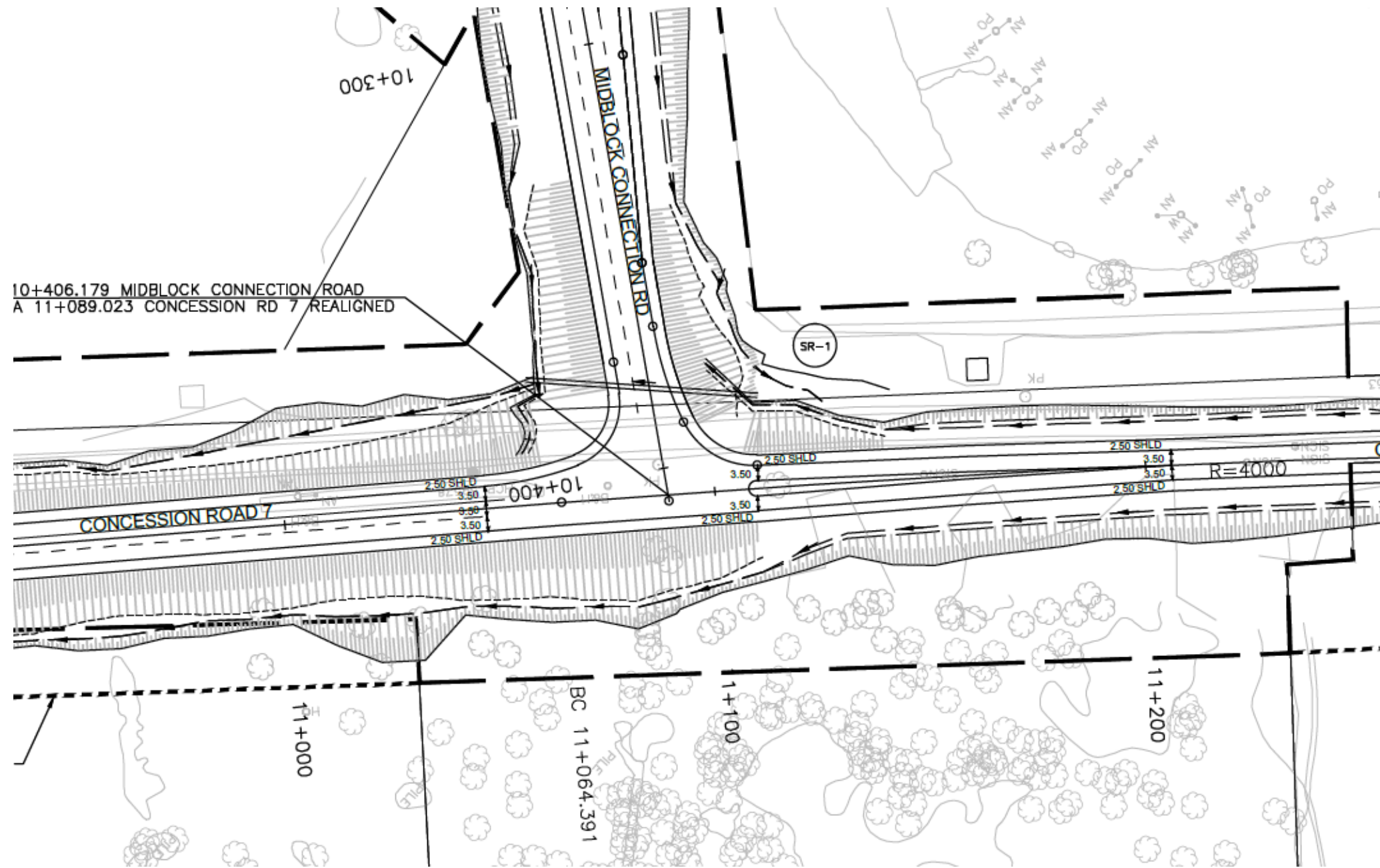

Figure 1 - Concession Road 7 and Midblock Connection Road Intersection

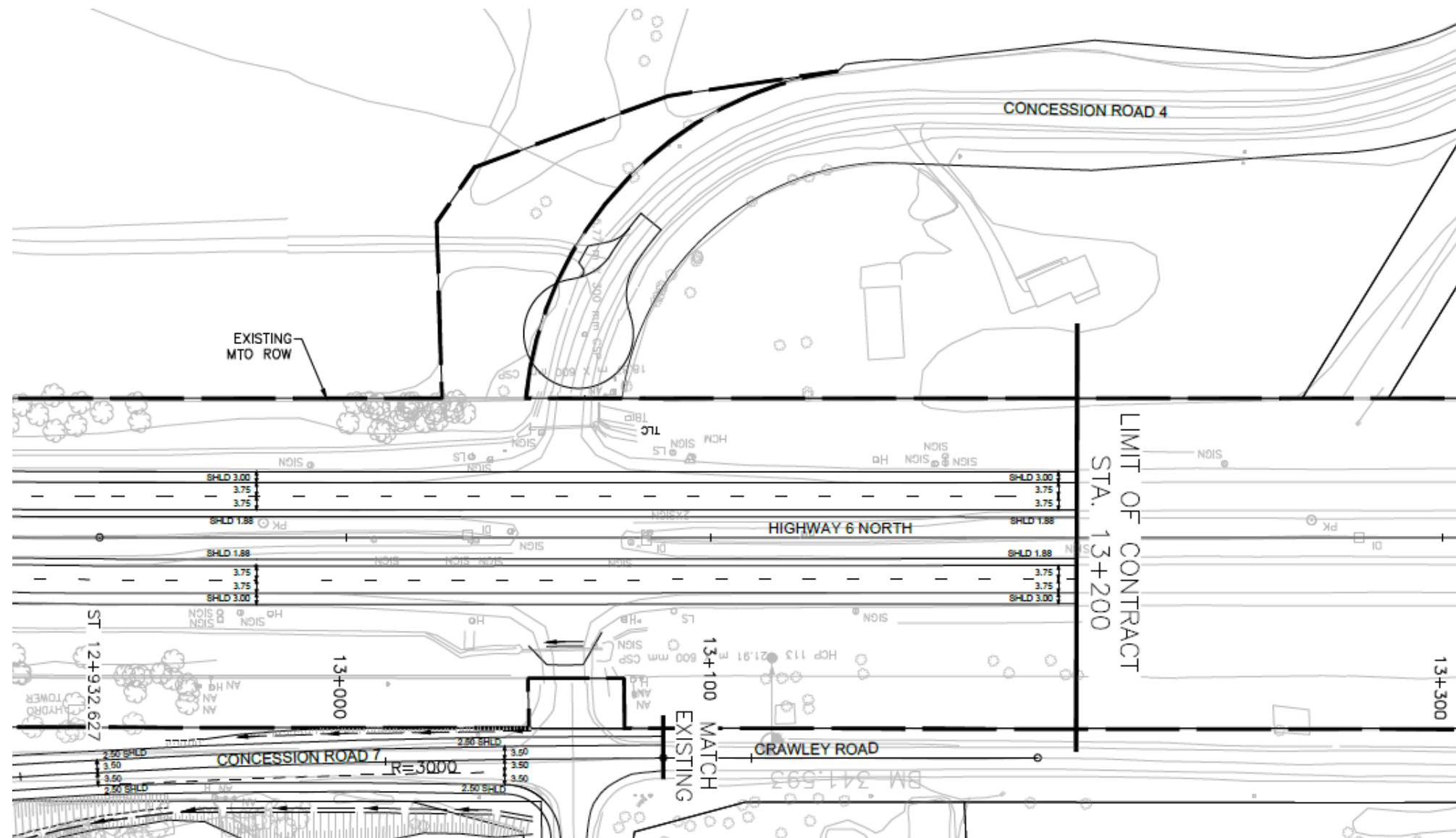

Figure 2 – Conversion of Concession Road 4 and the Highway 6 to a Cul-de-sac